

SWISS optio reduc LP with ejector



reduc LP ejector

The **reduc LP with ejector** at a glance:

- very silent use for permanent aspiration (up to – 150 mbar)
- continuous regulation of the vacuum
- available in three different ranges : up to -150 mbar, up to - 450 mbar or up to -700 mbar
- small-sized silencer / good readability of the gauge
- also available as basic version with regulating valve for connection on pressure reducing valve or take-off station via quick coupling
- the application is mainly in hospitals, clinics, medical practice and in emergency medicine

The field of application of the medical low pressure regulator **reduc LP with ejector** is mainly in the area of permanent aspiration and bronchoaspiration. The **reduc LP with ejector** is fed with air from a central gas supply system and is coupled directly with the country-specific probe into the extraction socket of the central gas supply system. The **reduc LP with ejector** thus generates the required vacuum. With the basic version with regulating valve, the ejector is directly connected via quick coupling or screwed connector to the cylinder pressure reducing valve.

The vacuum can be adjusted continuously on the low pressure regulator of the **reduc LP with ejector** or on the regulating valve of the ejector (basic version without low pressure regulator).

The integrated overpressure valve avoids overpressure on the side of the patient in case of faulty handling of the **reduc LP with ejector**. A mechanical overflow protection or a filter (which are not included) can be mounted which protects the equipment from excessive aspiration.

The **reduc LP with ejector** is in conformity with EN ISO 10524-4 and with all important points of EN ISO 10079-3. CE marking according to Guideline for Medical Products 93/42/EEC, annex IX, class IIb.

Technical data :

Construction	ejector with venturi nozzle
Supply pressure	GX10012 : 4 – 10 bar / GM76xx : 4.5 bar +/-0.5 bar
Vacuum regulation range	GX10012 : 0 up to -150 mbar (permanent aspiration), 0 up to - 450 mbar, 0 up to - 700 mbar / GM76xx : 0 up to - 700 mbar
Vacuum indication	0 - 250 mbar, 0 - 600 mbar, 0 - 1000 mbar
Throughput	GX10012 : 0 – 15 l/min, 0 – 25 l/min, permanent aspiration 0 - 8.5 l/min GM76xx : 0 – 20 l/min
Noise level	up to 65 dBA / permanent aspiration : up to 42 dBA
Gas	AIR, O ₂
Inlet	external thread G1/4", DIN, NF, AGA, BS, UNI probe (others on request), clamping rail bracket with NIST inlet
Outlet (aspiration)	hose nipple 6 mm
Silencer	diameter 22 mm (for mounting a filter), for permanent aspiration also available with diameter 22.5 mm (conical) for e.g. Dräger filter
Material	body brass, external parts nickel-plated
Sealing material	Cu, POM, FKM, PA6, MVQ, EPDM
Operating temperature	-20° up to +60°C
Dimensions	W x H x D : GX10012 : 47 x 135 x 149 mm, GM76xx : 145 x 86 x 60 mm (both in version with DIN probe)
Weight	1070 gr (GX10012), 390 gr (GM76xx)

Model variants GX10012 / GM76xx :

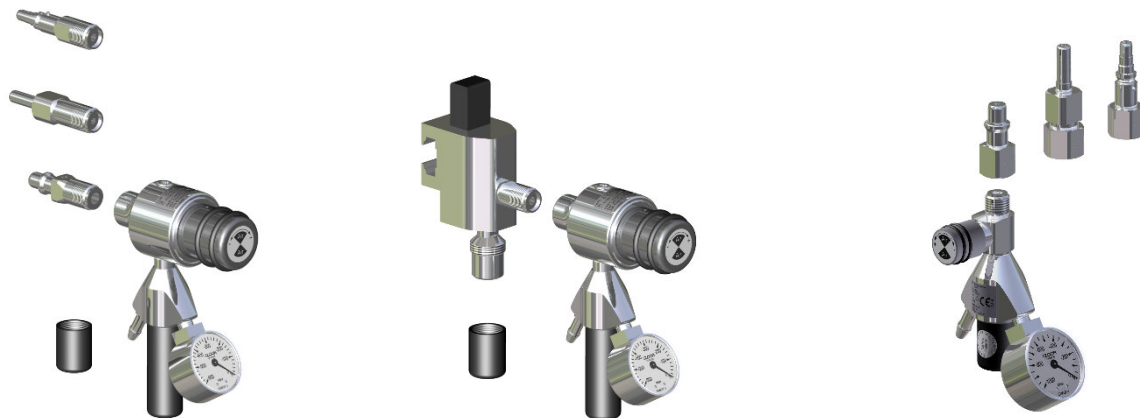

GX10012

GX10012 with clamping rail bracket

GM76xx

Necessary indication when ordering :

Version	GX10012, GM76xx
Gas	AIR, O ₂
Inlet	external thread G1/4", DIN, NF, AGA, BS, UNI probe, clamping rail bracket with NIST inlet
Silencer	diameter 22 mm or 22.5 mm conical

Subject to changes. All trademarks are property of Gloor Ltd..