

SWISS optio hoses

Connection hoses



The connection hoses at a glance:

- for the safe connection of pressurised gas and/or vacuum sources to the consumer
- high quality materials at the connections (stainless steel, nickel-plated brass) and the hoses
- connection hoses in ISO colour coded
- available in various international standards (DIN, BS, NF, Carbamed, Medap, AGA, UNI etc.)
- for mobile and stationary applications

These medical low-pressure hoses are used for the connection of pressurised gas and/or vacuum sources to the consumer. On the supply side the connection hose is equipped with a gas specific angle gas probe; on the consumer side with a gas specific NIST (or DISS) connection. There are three different models of (angle) gas probes at choice. The NIST and DISS connection is also available in a 90° (angle) version.

The high-quality materials also guarantee a safe connection and disconnection of the hose from the terminal unit over the long term. On demand, the angle gas probe can also be fitted with a non-return valve.

The connection hoses are available in standard lengths of 1.5, 3 and 5 metres. Also available in special lengths on request.

The connection hoses meet the requirements of EN ISO 5359. CE marking according to the Guideline for Medical Products 93/42/EEC.

Technical data:

Classification	equipment classification according CE Guideline 93/42 EEC Annex IX, class IIa
UMDNS-Code	16-780 connection hose for compressed gases 16-779 connection hose for vacuum devices (nomenclature for medical products)
Operating pressure	max. 14 bar
Flow	200 l/min at 3.2 bar
Pressure loss	0.8 bar at 3.2 bar and 200 l/min
Gas	Air, O ₂ , CO ₂ , N ₂ O, VAC
Inlet	DIN, NF, AGA, BS, Carbamed, Medap, UNI probe (others on request), NIST, DISS
Outlet	NIST, NIST 90°, DISS, DISS 90°, DIN coupling etc.
Material	brass nickel-plated, stainless steel, PVC-P
Sealing material	FKM 75, NBR 70
Operating temperature	-10° up to +40°C
Weight	320 - 350 gr (according to angle probe and DIN version 1.5 m)

Model variants:

GM2xxx

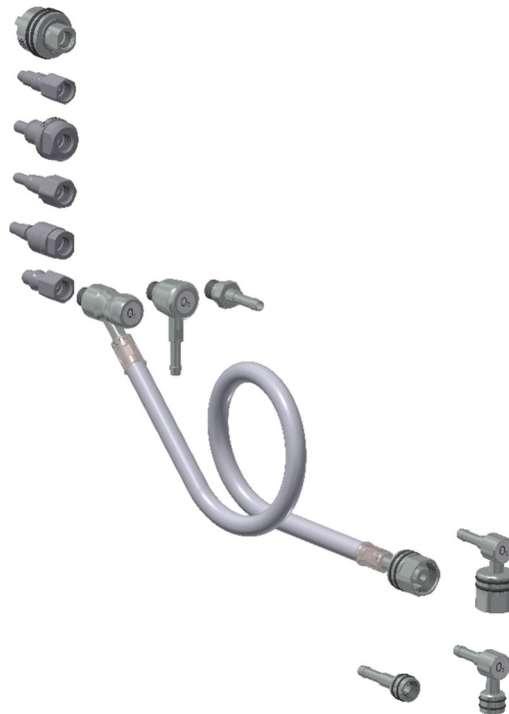

Necessary information when ordering:

Gas	AIR, O ₂ , CO ₂ , N ₂ O, VAC
Length	1.5 m / 3 m / 5 m (special lengths on request)
Angle probe	Basic version, version, 90°, straight version
Inlet	DIN, NF, AGA, BS, Carbamed, Medap, UNI, NIST
Outlet	NIST, NIST 90°, DISS, DISS 90°

Subject to changes. All trademarks are property of Gloor Ltd.

GLOOR

GLOOR LTD
Kirchbergstrasse 111
3400 BURGDORF
SWITZERLAND

www.gloor-medical.ch
info@gloor-medical.ch
Tel.: +41 34 427 47 47