

SWISS optio reduc hp1

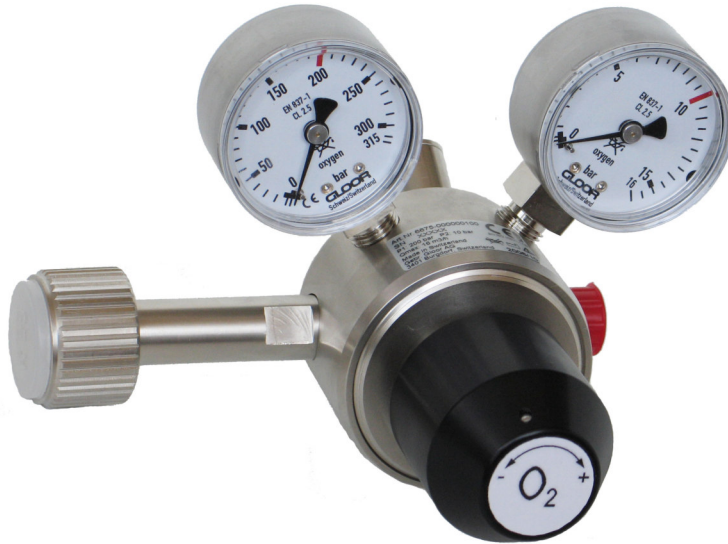

reduc 1

The **reduc hp1** at a glance :

- For the variable regulation of a working pressure of 0-10 bar
- Also available with fixed working pressure
- High flow capacity
- For the direct connection of one or two consumers
- With integrated pressure relief valve
- Mainly intended for use in clinics

The **reduc hp1** medical pressure reducing valve is used for the direct supply of one or two consumers with medical gas at a variable or fixed supply pressure from a high-pressure gas cylinder.

The **reduc hp1** is fitted with a high pressure gauge for the cylinder pressure and a low pressure gauge for indication of the set working pressure (both gauges according EN 837-1). Depending on the model, the desired working pressure can be set using the regulating handle on the pressure reducing valve, or can be set to a fixed pressure at the factory.

As an option, the **reduc hp1** can have two outlets. The two outlets are used for the direct supply of medical equipment, of flow measuring devices or also for the direct feed to the emergency supply of a central medical gas supply system.

The **reduc hp1** meets the requirements of EN ISO 10524-1 (incl. ignition test for oxygen); CE marking according to the Guideline for Medical Products 93/42/EEC.

Technical data :

Construction	Single-stage diaphragm pressure reducing valve
Inlet pressure	200 bar
Outlet pressure	Adjustable 0-1.5 / 0-4 / 0-6 / 0-10 bar, or preset at customers request
Flow rate	$Q_1 = 16 \text{ Nm}^3/\text{h} / Q_{\text{max}} = 17 \text{ Nm}^3/\text{h}$
Irregularity coefficient i	< 0.1 (P1=200...20 bar)
Gas	Air, O ₂ , CO ₂ , N ₂ O, N ₂ , He, Xe, test gas mixtures
Inlet	Cylinder conection DIN, NF, AGA, BS, PIN-Index, UNI (others on request)
Outlet	G1/4" inner thread (one outlet downward, one outlet lateral), NIST, quick coupling
Material	Brass body, external parts nickel-plated
Sealing material	EPDM, Si, PA, PEEK
Operating temperature	-20° to +60°
Dimensions	W x H X D : 165 x 117 x 115 mm
Weight	1.8 kg

Model variants Art.No GM615x :

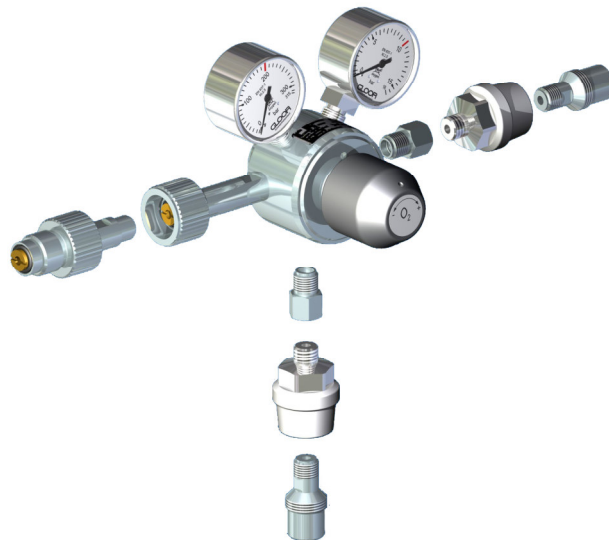

Necessary information when ordering:

Gas	Air, O ₂ , CO ₂ , N ₂ O, N ₂ , He, Xe, test gas mixtures
Outlet pressure	0 - 1.5 / 0 - 4 / 0 - 6 / 0 - 10 bar with adjustable versions, the desired working pressure with preset versions
Inlet	DIN, NF, AGA, BS, UNI, PIN-Index
Outlet	One or two outlets open, G1/4" inner thread, NIST, quick coupling

Subject to changes. All trademarks are the property of Gloor Ltd.